

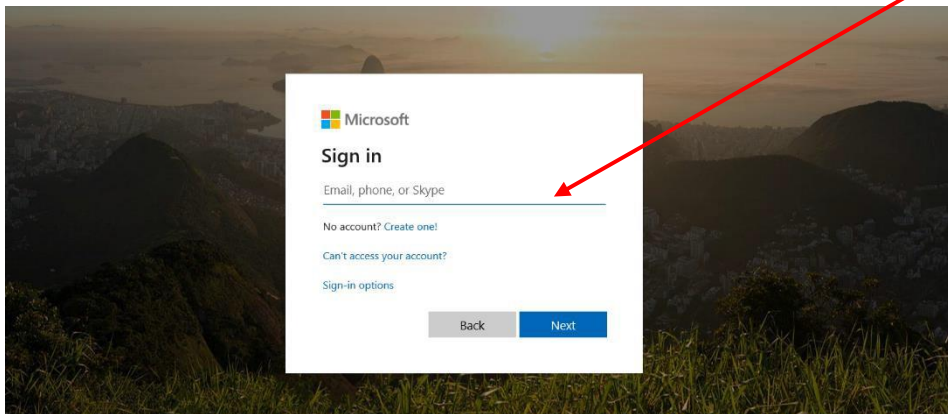

STUDENT LOGIN *Instructions*

Website Access

1. Enter carliseschools.schoolology.com into your browser (Google Chrome or Microsoft Edge).
2. You will be redirected to the **MICROSOFT LOGIN** screen. Enter your **STUDENT EMAIL** address in the first field (*username@carlislestudents.org*).



3. The next screen will ask for your password. This is the **same password** used to get onto the student laptop (not iPad) and OneDrive (O365).

Finding my Classes

1. Your current schedule has been imported into Schoology from PowerSchool.
2. Click on **COURSES** from the top menu bar to see which classes you are a member of.

